

# Wyoming Certified Land Corner Recordation Certificate

*This form is to be completed in accordance with W.S. 36-11-101, printed in black ink or typed, and shall be for one individual corner.*

Describe below, or show in sketch attached to this form, the corner evidence found. Include condition and type of monument, accessories and ties. Describe any maintenance or rehabilitation performed. In the circle to the right, show monument inscription. If monument is determined lost or obliterated, restate the GLO or BLM original field note record; describe or show the procedure used to reestablish the corner and all data as above for a found monument.

Field Date 7/19/91 Office Reference \_\_\_\_\_

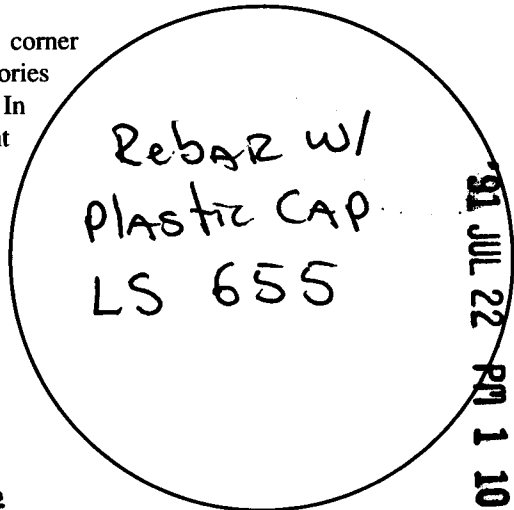

RECEIVED  
 LARAMIE COUNTY 087248  
 CHEYENNE, WY.

Monument Inscription

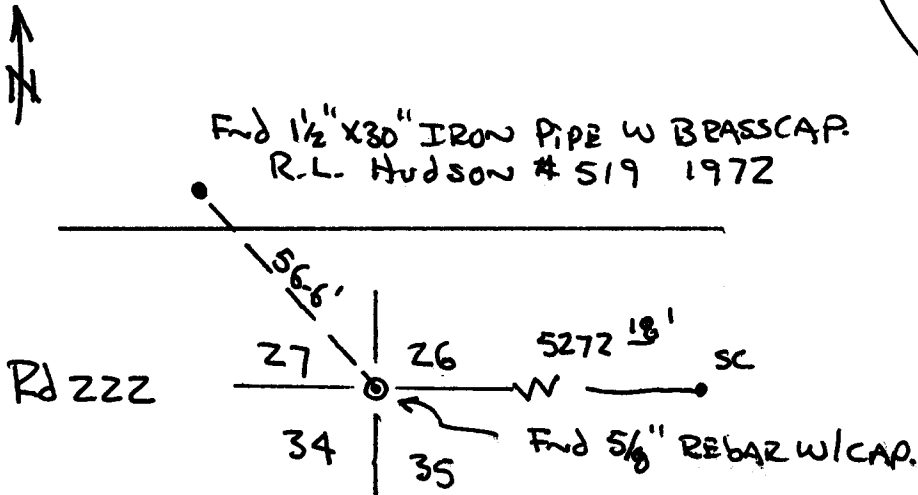

Found & Reverified  
 Corner Recordation of  
 R.L. Hudson # 519  
 Dated 9 Aug 1972  
 Page 16-65 - Book ONE

State of Wyoming  
 Office of County Clerk  
 County of LARAMIE

This Certified Land Corner Recordation Certificate was filed for record on the \_\_\_\_\_ day of \_\_\_\_\_, 19 \_\_\_\_, in Book No. T \_\_\_\_\_, R \_\_\_\_\_, on Alpha-Numeric coordinates N-17 and was noted on the Cross Index Plat.

County Clerk

Corner Type:  Aliquot Corner  Other  
 Section(s) 26 Meridian 6th  
 Corner Name Section Township 16N Range 65W Page \_\_\_\_\_  
 Sheet 1 of 2

**BOOK 1306**

**Directions for using the  
Cross Index Plat**

Section, quarter and sixteenth corners will be marked with a dot at the corner location. The alpha-numeric coordinate number is then determined for the intersection of the two lines. A corner that applies to two or more townships shall be filed under all that apply by the use of photo copies.

Closing corners will be indexed under the township in which they control ownership. For 1/64, 1/256, 1/1024 and non-aliquot corners lying between grid designations, mark the appropriate grid area with a dot and use the index code to the north and west (local systems may be used if the method is approved by the County Surveyor or Clerk and a written description of its use is filed in the front of each book of certificates).

**Cross Index Plat**

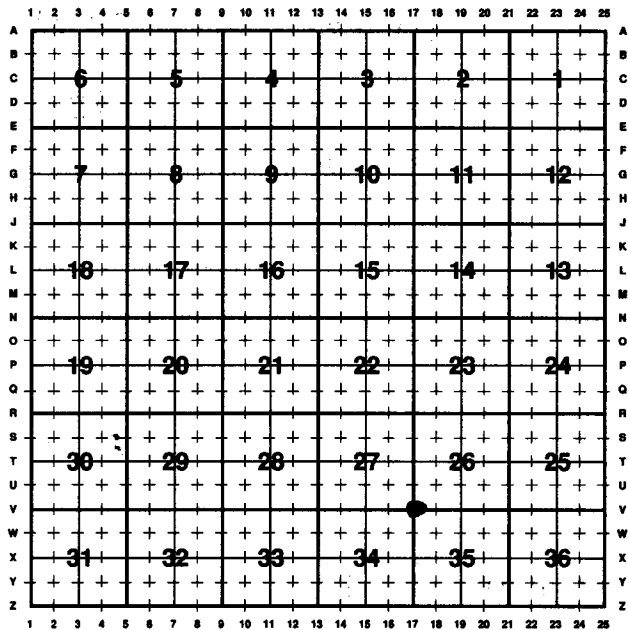

**State Plane Coordinates (optional)**

Zone  W  WC  EC  E feet/meters  
 NAD 1927  NGVD 1929  NAD 1983  NAVD 1988  
 North (Y) = \_\_\_\_\_ East (X) = \_\_\_\_\_ EL = \_\_\_\_\_  
 Latitude \_\_\_\_\_ Longitude \_\_\_\_\_  
 Scale Factor \_\_\_\_\_ Geoid Height \_\_\_\_\_

**Certification**

I, JAMES D. VOELLER, Wyoming PLS/PE 2617 certify that I, or others under my supervision, have performed the work as described above and completed this form.

Company or Agency AVI  
 Mailing Address 2035 Westland Road  
 Street Address Cheyenne Wyo  
 City, State, ZIP 82001  
 Telephone, FAX 637-6017

*[Handwritten Signature]*



Signature, Seal, and Date